

**SOLE
AGENT**



Flat 1 Cranbrook

Grandes Maisons Road, St. Sampson, GY2 4JH

 x1  x1 **PERRYS 11 E4 TRP 55**

- Superb ground floor apartment
- Close to amenities in St Sampson's
- Well proportioned accommodation
- Double bedroom and three piece bathroom
- Allocated parking for two cars
- Ideal first-time buy, investment or downsize

£375,000

LOCAL MARKET

swoffers



sales@swoffers.co.uk | 01481 711766

Estate House, Ann's Place, St Peter Port, Guernsey, Channel Islands, GY1 2NU





About Flat 1 Cranbrook

Situated within easy reach of local amenities in St Sampson's, "Flat 1 Cranbrook" is a well presented ground floor apartment offering bright and well-proportioned accommodation throughout. The property features an immaculate fitted kitchen, complemented by a spacious lounge/dining room ideal for both relaxing and entertaining. A generously sized double bedroom and three-piece bathroom complete the internal accommodation. Externally, the apartment benefits from a west facing patio and allocated parking for two cars. An excellent opportunity for first-time buyers, those looking to downsize, or investors alike.

ACCOMMODATION COMPRISING

GROUND FLOOR

Kitchen

10'8" x 9'4" (3.25m x 2.84m)

Fitted with a range of medium wood wall and base units with laminate work surfaces over incorporating 1 ½ bowl sink and drainer.

Lounge / Dining Room

13'9" x 11'6" (4.2m x 3.5m)

Inner Hallway

5'7" x 3'8" (1.7m x 1.12m)

Bedroom

11'9" x 10'4" (3.58m x 3.15m)

Bathroom

8'10" max x 7'4" max (2.7m max x 2.24m max)

OUTSIDE

Front

The property is approached over a flagstone courtyard bounded by low height walls, this leads to the parking area where there is allocated parking for two cars.

Appliances

Neff electric oven and hob, stainless steel extractor, Indesit fridge/freezer, Hotpoint washing machine.

TRP: 55

Viewing: BY APPOINTMENT

Possession: BY ARRANGEMENT

Services: Mains water, electricity and drainage.

Electric night storage heating.

Construction: Cavity. uPVC double glazed windows.

Price includes: Carpets, curtains, light fittings and appliances as listed.

Ground Floor

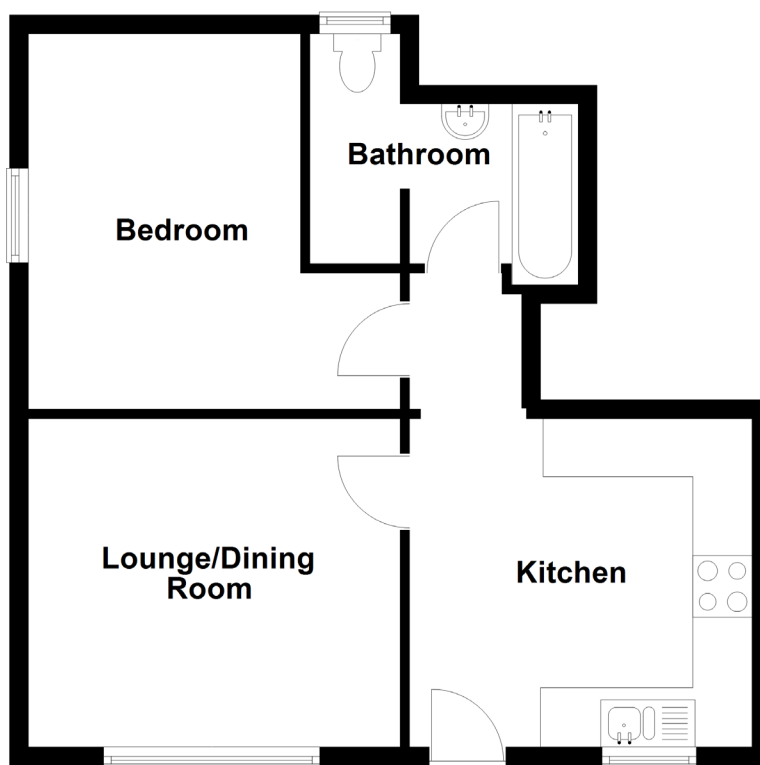

swoffers



sales@swoffers.co.uk | 01481 711766

Estate House, Ann's Place, St Peter Port, Guernsey, Channel Islands, GY1 2NU

These particulars, whilst believed to be accurate are set out as a general outline only for guidance and do not constitute any part of an offer or contract. Sketch plans for illustrative purposes only. All measurements, walls, doors, windows, fittings and appliances, their sizes and locations are shown conventionally and are approximate only and cannot be regarded as being a representation either by the Vendor or their Agent, Swoffers Limited. Intending purchasers should not rely on them as statements or representations of fact or that the property or its services or any systems or equipment are in good condition, but must satisfy themselves by inspection or otherwise as to their accuracy and operative condition. Any reference to alterations to, or use of, any part of the property is not a statement that any necessary planning, building regulations or other consent has been obtained. These matters must be verified by any intending purchaser. No person in this firm's employment has the authority to make or give any representation or warranty in respect of the property.