



Rockview

Route de la Rocque Poisson, St. Pierre Du Bois, GY7 9HW

 x4  x2 **PERRYS 20B3 TRP 240**

- Four bedroom detached cottage
- Large separate outbuilding
- Versatile kitchen/breakfast room
- Enclosed rear garden
- Stunning west coast views
- Ample parking

£975,000

LOCAL MARKET

swoffers



sales@swoffers.co.uk | 01481 711766

Estate House, Ann's Place, St Peter Port, Guernsey, Channel Islands, GY1 2NU





About Rockview

'Rockview' is a beautifully presented detached home enjoying breathtaking views across L'Eree. This charming cottage has been thoughtfully extended by the current owners to create a spacious and versatile four-bedroom family residence.

The well-appointed accommodation comprises three bedrooms on the ground floor, along with a cosy snug, separate utility room, and a generous kitchen/breakfast room. Upstairs, a large living room makes the most of the stunning outlook, accompanied by a superb primary bedroom with en-suite bathroom. Externally, the property offers ample parking, a substantial patio area, and an extensive lawned garden. Additional features include a separate outbuilding, wooden shed, summer house, greenhouse, and a further block-built outbuilding.

Combining flexible living space with an exceptional location, this wonderful family home must be viewed to be fully appreciated.

ACCOMMODATION COMPRISING

GROUND FLOOR

Porch

5'3" x 4'11" (1.6m x 1.5m)
Two windows to each side.

Snug

14'9" x 12'10" (4.5m x 3.9m)
Original exposed beams. Window overlooking L'Eree bay. Electric fireplace.

Hallway

18'1" x 3'3" (5.5m x 1m)

Bedroom 4

10'6" x 8'6" x 10'6" (3.2m x 2.6m x 3.2m)
Exposed beams. Pine fitted wardrobe space. Window providing aspect to the side of the property.

Bedroom 3

10'6" x 9'6" (3.2m x 2.9m)
Exposed beams. Fitted pine wardrobe. Window overlooking the rear of the property.

Bathroom

8'6" x 6'7" (2.6m x 2m)
Fitted with a three piece suite including a shower, WC and wash hand basin set into vanity unit with a wall mounted mirror. Marble effect tiled flooring.

Utility Room

6'7" x 5'11" (2m x 1.8m)
Fitted with a range of wall and base units. Door giving access to the side of the property.

Kitchen

16'5" x 15'1" (5m x 4.6m)
Fitted with arrange of wall and base units as fitted incorporating a 1 ½ bowl sink and drainer. Window providing aspect over the garden.

Breakfast Room

19' x 11'6" (5.8m x 3.5m)
Tiled flooring. Two windows to the side. Double doors opening to the garden. Wooden ceiling.

Bedroom 2

11'2" x 10'6" (3.4m x 3.2m)
Fitted wardrobe. Original beamed ceiling. One window providing view of L'Eree.

SECOND FLOOR

Living Room

20'8" x 12'2" (6.3m x 3.7m)
Two windows providing lovely views over L'Eree Bay. Fitted pine storage including a television unit. Velux window providing views onto the garden.

Bedroom 1

22'8" x 10'6" (6.9m x 3.2m)
Fitted wardrobe. Two Velux windows providing aspect over the side of the property.

Ensuite Shower Room

10'6" x 7'7" (3.2m x 2.3m)
Fitted with a four piece suite including, a shower, WC, bidet and wash hand basin set into vanity unit. Large Velux window providing aspect over the side of the property.

Outbuilding

23'4" x 10'10" (7.1m x 3.3m)
The outbuilding has a loft area and power supply.

OUTSIDE

Front

The front of the property is approached over a gravel area with parking for one car.

Rear

There is a gate with access to a large patio/parking area which then leads to an immaculately kept large lawned garden with views over the fields behind the property.

Garden

Three sheds and a small greenhouse.

Appliances

NEFF double oven, NEFF extractor fan, NEFF induction hob, NEFF integrated microwave, Hotpoint tumble dryer and AEG washing machine.

TRP: 240

Viewing: BY APPOINTMENT

Possession: BY ARRANGEMENT

Services: Mains water, electricity and cesspit drainage.

Construction: Cavity construction. uPVC double glazed windows, uPVC fascias and soffits and oil fired central heating with electric underfloor in the shower room.

Price includes: Carpets, curtains, light fittings and appliances as listed.

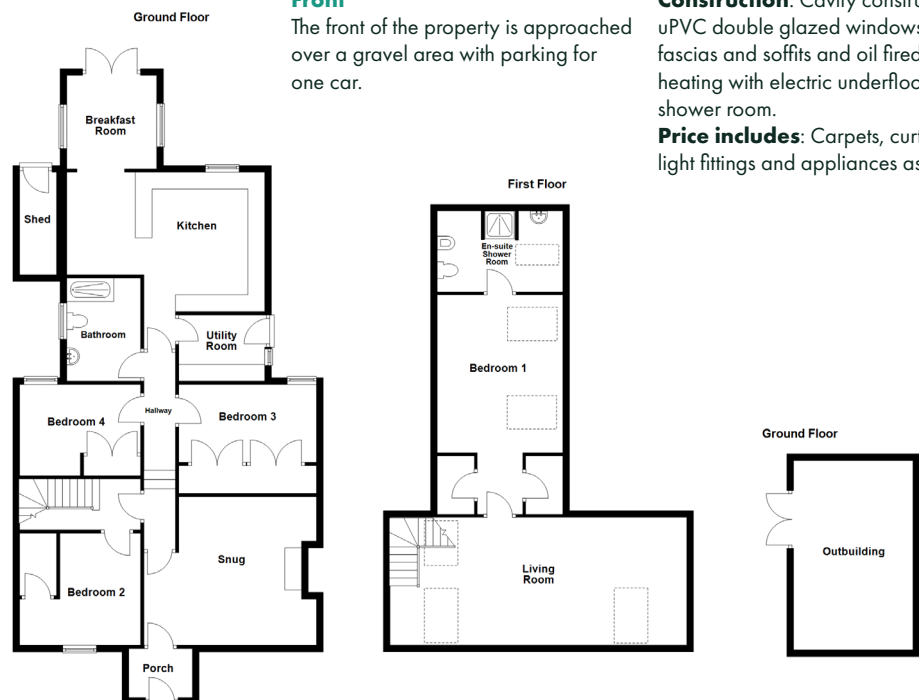

swoffers



sales@swoffers.co.uk | 01481 711766

Estate House, Ann's Place, St Peter Port, Guernsey, Channel Islands, GY1 2NU

These particulars, whilst believed to be accurate are set out as a general outline only for guidance and do not constitute any part of an offer or contract. Sketch plans for illustrative purposes only. All measurements, walls, doors, windows, fittings and appliances, their sizes and locations are shown conventionally and are approximate only and cannot be regarded as being a representation either by the Vendor or their Agent, Swoffers Limited. Intending purchasers should not rely on them as statements or representations of fact or that the property or its services or any systems or equipment are in good condition, but must satisfy themselves by inspection or otherwise as to their accuracy and operative condition. Any reference to alterations to, or use of, any part of the property is not a statement that any necessary planning, building regulations or other consent has been obtained. These matters must be verified by any intending purchaser. No person in this firm's employment has the authority to make or give any representation or warranty in respect of the property.