

SOLE
AGENT

7 Maison le Marchant

Grandes Maisons Road | St Sampson | GY24JP

This immaculate first floor modern flat is conveniently located near the amenities of The Bridge and within walking distance of Delancey Park. Accommodation comprises lounge/diner, kitchen, bedroom and bathroom. The property benefits from an underground parking space for one car, visitor parking and use of the communal garden. Regret no smokers, pets or children. Available 1st July until 31st May 2027.

1 BEDROOM

1 BATHROOM

1 RECEPTION

£1,600 pcm

Shields
& Rutland

PHOTOS



PHOTOS



SPECIFICATIONS



Hallway

1.91m x 0.96m (6' 3" x 3' 2")

Lounge/Diner

5.40m x 3.37m (17' 9" x 11' 1")

Kitchen

3.80m x 1.62m (12' 6" x 5' 4")

Bedroom

3.34m x 3.01m (10' 11" x 9' 11")

Shower Room

2.42m x 1.57m (7' 11" x 5' 2")

Parking

There is underground parking for one car.

Garden

There is an communal garden to the rear.

PRICE INCLUDES

Blinds, carpets/flooring and light fittings. Bed, table, chairs and sofa.

SPECIAL FEATURES

- uPVC double glazed
- Underground parking
- Convenient location
- Communal garden

SERVICES

Mains water, electricity and drainage.

APPLIANCES INCLUDED

- Four ring hob
- Single oven
- Extractor fan
- Fridge/freezer
- Washing machine

SCHOOL CATCHMENT

n/a

FIRST FLOOR

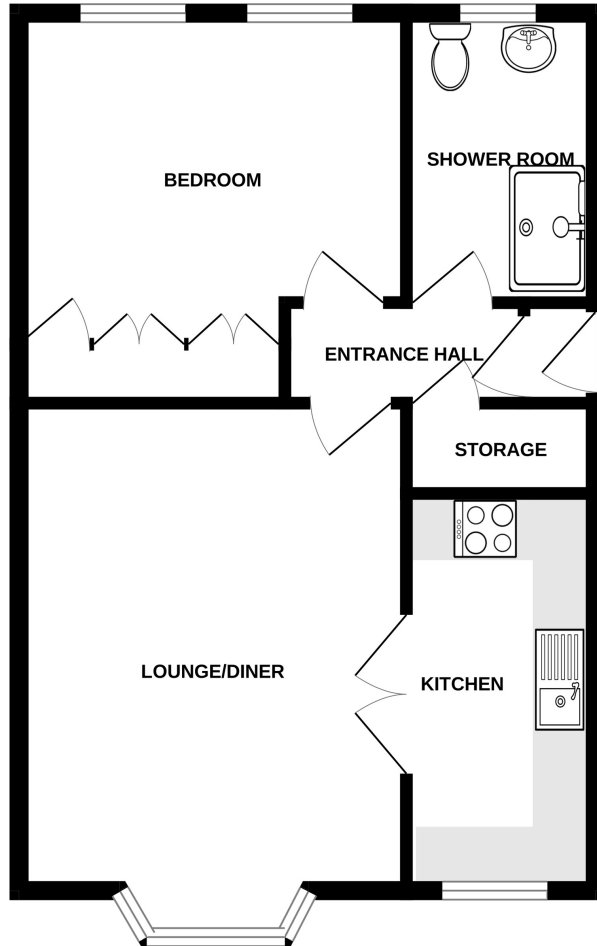

7 MAISON LE MARCHANT

Whilst every attempt has been made to ensure the accuracy of the floorplan contained here, measurements of doors, windows, rooms and any other items are approximate and no responsibility is taken for any error, omission or mis-statement. This plan is for illustrative purposes only and should be used as such by any prospective purchaser. The services, systems and appliances shown have not been tested and no guarantee as to their operability or efficiency can be given.
Made with Metropix 62025

T 01481 714445
E info@shieldsandrutland.gg

Shields & Rutland, Le Foulon Business Centre Le Foulon, St Peter Port,
GY1 1YR

shieldsandrutland.gg

Shields
& Rutland

OPENING DOORS SINCE 1993