

Coming Soon



Two bedroom apartment with parking for one vehicle.

43 Millmount, La Charroterie, St Peter Port, GY1 1EL

£2,000 pcm



- First floor, two bedroom apartment
 - Offering good space throughout
- Benefit of underground parking for one vehicle
 - Situated in a convenient central location
 - Available July 2026

Local Information

A local market property in Guernsey which can only be occupied by those who are locally qualified or hold a current local permit

About this property

This first floor apartment forms part of the Millmount development on the outskirts of St Peter Port.

Offering good size accommodation throughout, the property comprises entrance hallway, living room, fully fitted kitchen, two double bedrooms and a bathroom.

Externally, the property benefits from underground parking for one vehicle.

Furnishing

Unfurnished

Additional Information

Term: One Year Minimum

Services: Mains water, electricity, gas and drainage.

Gas fired central heating.

Available: July 2026

Deposit: Equivalent to one month's rent

Directions

Travelling down La Charroterie from the roundabout at Ruelle Brayes, Millmount is situated on the right hand side almost opposite Sir Charles Frossard House.

Viewing

All viewings will be accompanied and are strictly by prior arrangement through Savills Guernsey Lettings Office.

Telephone: +44 (0) 1481 810 300.



FIRST FLOOR

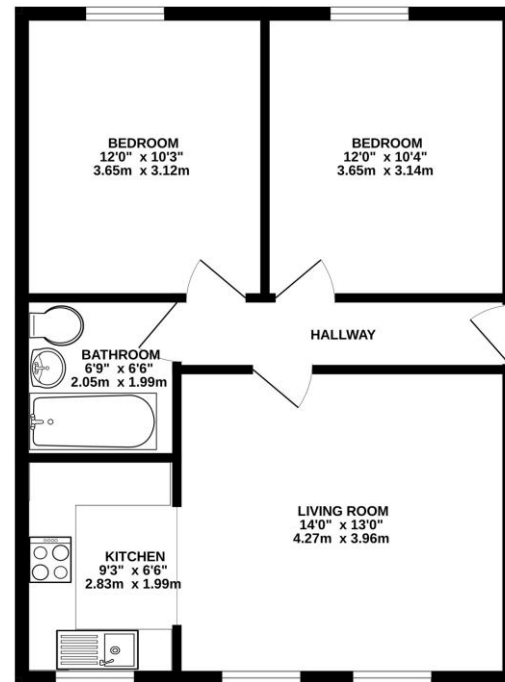

While every attempt has been made to ensure the accuracy of the floorplan contained here, measurements of doors, windows, rooms and any other items are approximate and no responsibility is taken for any error, omission or mis-statement. This plan is for illustrative purposes only and should be used as such by any prospective purchaser. The fixtures, systems and appliances shown have not been tested and no guarantee as to their operability or efficiency can be given.
Made with Metropce ©2024

Important notice Savills, their clients and any joint agents give notice that: 1. They are not authorised to make or give any representations or warranties in relation to the property either here or elsewhere, either on their own behalf or on behalf of their client or otherwise. They assume no responsibility for any statement that may be made in these particulars. These particulars do not form part of any offer or contract and must not be relied upon as statements or representations of fact. 2. Any areas, measurements or distances are approximate. The text, images and plans are for guidance only and are not necessarily comprehensive. It should not be assumed that the property has all necessary planning, building regulation or other consents and Savills have not tested any services, equipment or facilities. Prospective tenants must satisfy themselves by inspection or otherwise. Please note that the local area may be affected by aircraft noise, you should make your own enquiries regarding any noise within the area before you make any offer.

*There are different rules and fees for different tenancy types. For details of our fees and charges please go to [Savills.co.uk/tenant-fees](https://savills.co.uk/tenant-fees). For more detailed information read our applicant guide at savills.co.uk/applicant-guide. Hard copy available on request. . 20260626MDBT



arla | **propertymark**

PROTECTED